

S.W. 1/4 OF  
SECTION 15, T.6N., R.1W., S.L.B. & M.

IN OGDEN CITY  
SCALE 1" = 200'

ALSO SEE PAGE 107-1

TAXING UNIT: 25

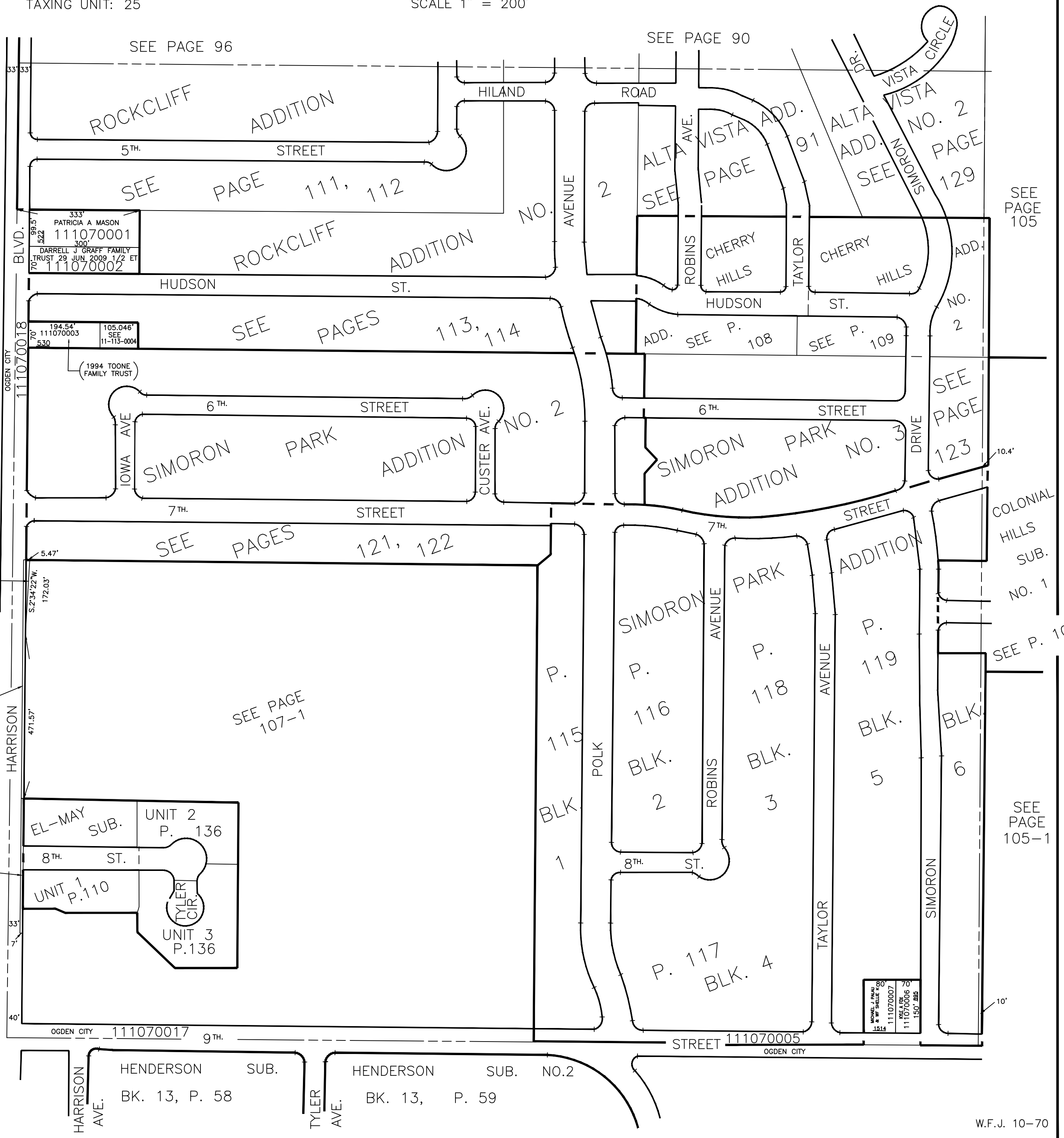

SEE BOOK 12  
PG. 31

STATE ROAD  
COMM  
(111070012)

(OGDEN CITY)  
(111070011)  
7' X 643.5'

(OGDEN CITY)  
(111070016)